

#### Detail 4. Isolation Joint

The flexible epoxy membranes are engineered to handle movement in the horizontal plane. They are not engineered to accommodate movement in the vertical plane, as a result of vertical shear due to substrate settlement or excessive deflection. Slabs to receive terrazzo flooring should accommodate Isolation Joints where the slab is separated from the load bearing columns or walls for this specific purpose.

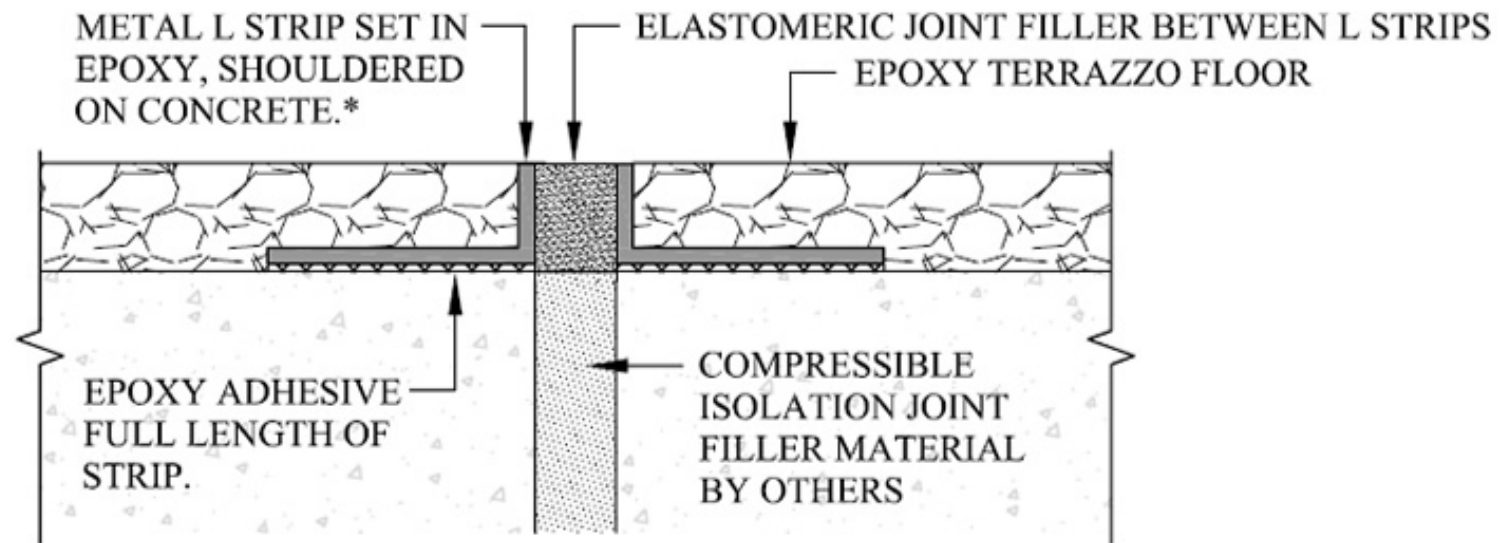

Scale: Full Scale

04/09

\*Care should be taken by concrete contractor to provide a straight joint, placed in coordination with design teams consideration of final grid pattern. Square edges are encouraged. Tooled edges are discouraged.